



Campaign Booklet

"Now to him who is able to do immeasurably more than all we ask or imagine, according to his power that is at work within us, to him be glory in the church and in Christ Jesus throughout all generations, for ever and ever! Amen."

Ephesians 3:20-21

*"King David rose to his feet and said:
'listen to me, my brothers and my
people. I had it in my heart to build
a house as a place of rest for the ark
of the covenant of the Lord, for the
footstool of our God, and I made
plans to build it.'" 1 Chronicles 28:2*



From the Pastor...

Dear Friends in Christ,

Whenever we try to imagine something in the future, we are limited. We are limited creatures; we are human; we are sinners. God, however, has no such limitations. He is God! He is all-powerful, all knowing, ever-present; He is eternal. God always has and always will be able to exceed what we can imagine or accomplish.

Back in February of 1977, when Lord of the Lakes held its first mission service at Lakeside Elementary and 28 people braved the -44 below zero temperatures, who could have imagined how God would bless this congregation?

In 1982, when we dedicated our new church, who could have imagined what God would do and how our church would grow? Who could have imagined the lives God would touch and change? Who could have imagined the people and facilities we now enjoy and have the opportunity to share as we reach out with the Good News of Jesus Christ?

In 1999, who could have imagined that we would need to expand again? Needing space for a larger kitchen, fellowship hall, offices, education space and to enlarge our worship area we gathered under the theme "Building on Faith" and that we did! With faith, prayer and commitment we stepped out again and expanded our church home. And God has continued to bless us beyond what we can imagine.

Now, in 2016 (as we near our 40th Anniversary), we look forward to what God continues to do through us as good stewards for His Kingdom. We are again at a point of needing to expand our facility to accommodate the growth of ministry: "Building community in Christ. Connecting people to the Word. Serving Christ together."

Because we can never imagine all that God can do, we have named our new capital stewardship campaign, "Immeasurably More." None of us can do what is needed by ourselves. That is why God has made each one of us part of the Body of Christ, to work together to do what He has called us to do. Collectively, as His people, God will work through us as we share our resources, share our time and talents in ministry, and reach even more people for Christ than we could have ever thought or imagined.

Please take a moment to go through this "Immeasurably More" campaign booklet. Hopefully it will answer any questions you might still have or give you insight into Lord of the Lakes' future. If you have not already begun praying, start today asking the Lord to direct you and to move you to take a step of faith that will greatly honor Him. Then watch what God will do.

It will be immeasurably more than you can imagine!

Rev. Craig Bertram

***"But God said to me...
'Solomon your son is the one who will
build my house and my courts...'"***

1 Chronicles 28:3-6

"Then David gave his son Solomon the plans....He gave him the plans of all that the Spirit had put in his mind for the courts of the temple of the Lord and all the surrounding rooms..."

1 Chronicles 28:11-12

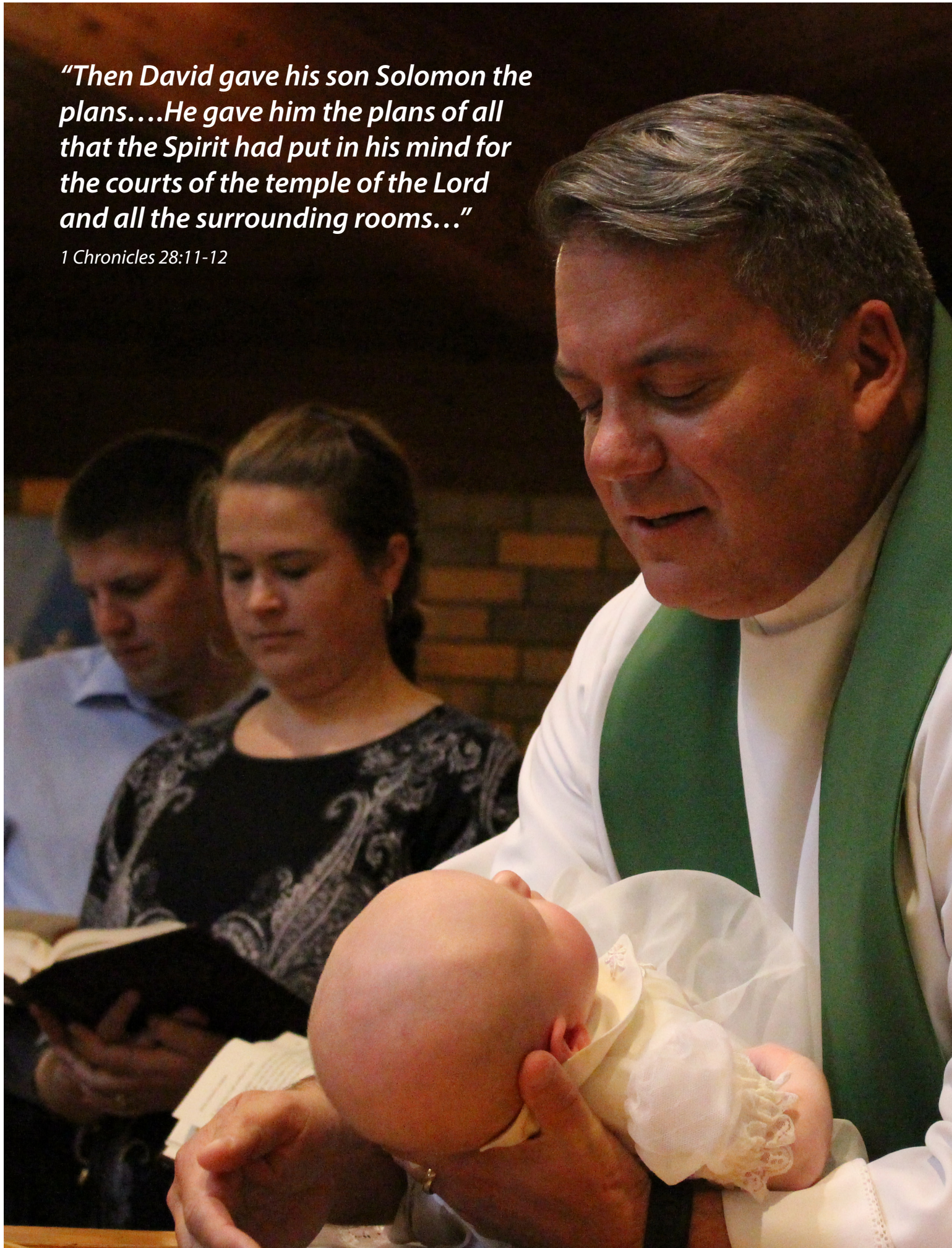

From The Youth & Education Director...

Who Knew???

The year was 1993; those in charge of Christian Education decide we should incorporate a Wednesday evening program for 4- 6th grade students in our ministry. They decide on the name "King Of Our Lives." KOOL Kids!

I was not a part of that inaugural year. I was however a Sunday school teacher for the Sr. High students. At that time I planned lock-in's, youth nights, and we did Youth Dinner Theater, and raked leaves for people.

One of my favorite memories is of the first lock-in that I led. One of the kids, not to mention names, (Dave Hustevdt) did not plan on staying the night. I asked him why he didn't plan on staying - his answer "I didn't think it would be any fun!" It was more fun then he could imagine!

That was back in the original building. I remember there really was not any room at all to do anything... much less play games! But somehow we managed to move things around and did we play! I remember using every inch of that building and thinking "I hope no one comes in here right now because I will be in big trouble!!" (Sometimes I still think that). God then blessed us to be able to expand giving the youth of the congregation "their own space" and it was more than I could imagine!

Our Youth Ministry at Lord of the Lakes has changed and grown. Now we host or go to Servant Events and the National Youth Gathering, Winter Youth Retreat, mentor nights and youth activities. On Wednesday nights we host KOOL KIDS, Confirmation, and Free Pie! If you have been in the building between 5-7 pm on a Wednesday, you not only find it buzzing with activity, but see kids who are excited to be at church on a Wednesday night – in the middle of the week – learning about God's Love for them! I hope that is more than what you could imagine!

As we continue to move forward in ministry here at Lord of the Lakes please join us in making a 3 year financial commitment to the building expansion. Please also join us in prayer, as we look forward to what God is doing here at Lord of the Lakes...

Immeasurably more!

Shelly Carlson

***"David also said to Solomon his son,
'Be strong and courageous, and do the
work. Do not be afraid or discouraged,
for the LORD God, my God, is with you.
He will not fail you or forsake you until all
the work for the service of the temple of
the LORD is finished.'" 1 Chronicles 28:20***

A close-up photograph of a hand placing a small, round, white wafer into a golden chalice. The chalice has a dark interior and a reflective gold rim. In the background, a stack of similar golden vessels is visible on the left, and a small, dark, textured object is on the right. The scene is set on a white surface.

"Then King David said to the whole assembly... 'With all my resources I have provided for the temple of my God.... Besides, in my devotion to the temple of my God I now give my personal treasures of gold and silver for the temple of my God, over and above everything I have provided for this holy temple...'"

1 Chronicles 29:1-4

Our Vision...

Building • Connecting • Serving

BUILDING COMMUNITY IN CHRIST

We worship as a community gathered around God's Word and the Sacraments to hear and experience the forgiveness of sins and salvation in Jesus Christ. As our Lord comes to us in His Word and in the Lord's Supper, we celebrate his victory over sin and death. Lord of the Lakes welcomes all people to celebrate that victory with us.

We live with one another as a community of God's forgiven people. Lord of the Lakes is a warm and caring place, full of people who have found the joy of Christian friendship. Whether it is coffee hour after worship (come try the treats!!), Bible Study, the LWML, a youth activity, praying for each other in church and through the prayer chain, a planned social outing, a meal, or a fellowship dinner, you will find meaningful relationships among people who care about and for each other. We provide and encourage fellowship opportunities for people of all ages, from a very active youth group to our senior members. We see God at work through the words and actions of his people - wherever and whenever daily life is shared, not just at church.

CONNECTING PEOPLE TO THE WORD

We learn as a community gathered around God's Word. Christian education is a priority at Lord of the Lakes. We offer a wide variety of educational opportunities to meet the needs of all people. These opportunities include Sunday School for all ages, Adult Bible Study, Small Group Bible Study, Wednesday evening youth and children's programs (KOOL Kids), confirmation, and more. All of our education programs are grounded in the Word.

Most all of our activities and groups at Lord of the Lakes have a time of devotion or study; from the Men's Bible Breakfast group to the ladies of the LWML. Each month with "Missions and Memory" a new bible verse is highlighted with the hope it will be memorized.

SERVING CHRIST TOGETHER

We respond to God's love in Jesus by offering ourselves in joyful service to our Savior, his Church, and his people. There are many opportunities to get involved in works of witness and service. Members on our boards and committees see to it that the work of the church is done effectively and efficiently. Others prefer to serve by reaching out to those in our community with caring ministries. Still others give of their time and talents to teach the children of our church. There is always a place to serve and help others.

PROPOSED EXPANSION / RENOVATION
LORD of the LAKES LUTHERAN CHURCH
 CHISAGO CITY, MINNESOTA

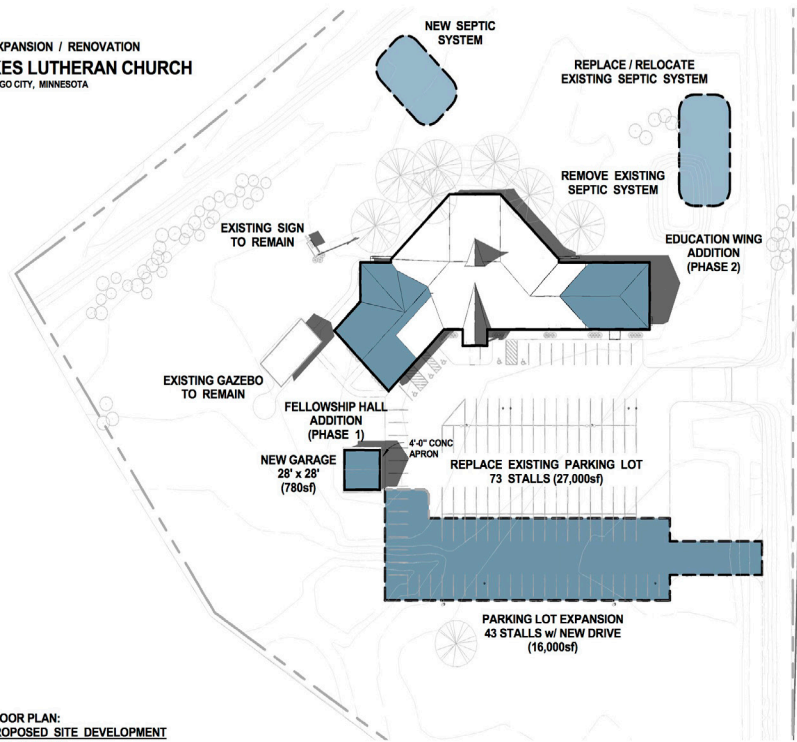

1 FLOOR PLAN:
PROPOSED SITE DEVELOPMENT
 DATE: 9-28-2016



SCOPE OF WORK LEGEND

- Existing Space
- New / Remodeled Space

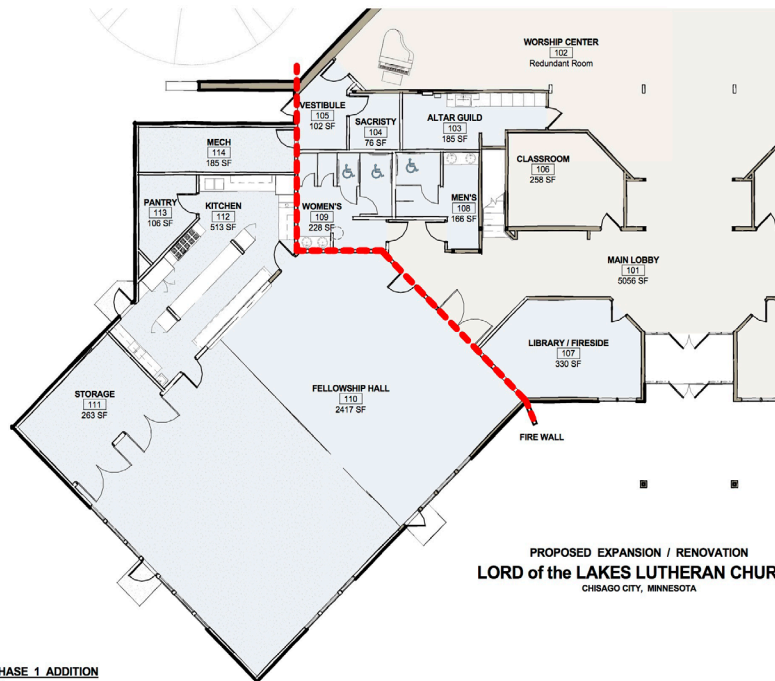

PROPOSED EXPANSION / RENOVATION
LORD of the LAKES LUTHERAN CHURCH
 CHISAGO CITY, MINNESOTA



2 FLOOR PLAN:
PROPOSED PHASE 1 ADDITION
 DATE: 9-28-2016



Why expand - Our “Case Statement”...

Imagine a place where people can experience immeasurable love; more than they ever thought possible. A place where people can feel like they belong and they can be part of something bigger than their everyday lives. Where there is room for them and place for them. Where they can feel connected to Christ and a community of believers who want to learn and grow in God’s Word, truth, and love. Where they feel welcomed.

It’s happening! God is at work among us and in our Church. We rejoice in what God has done and look forward to what He will do, which will be immeasurably more than what we can imagine or dream. Our building has served us well, but as our ministry has grown and prospered the space that we currently have is being outgrown in every area and age group.

Recall the last time we had Missions and Memory and there was standing room only, or the last soup supper we had and there were only a few chairs left. If you have ever been in the church on a Wednesday when there is confirmation, KOOL Kids, choir and the occasional meeting you know how our ministries have prospered and how we have begun to outgrow our building. Our Sunday school rooms are close to being full and there is not enough seating when the Sunday school gathers as a large group. Even our worship space at times is not adequate for those in attendance.

We have prayed, studied, shared information, and as a congregation made the decision that we need to expand our building to continue to grow our ministry. We want to share what we have and what we value with our community - reaching out to all people and all ages. The expansion that we have approved includes doubling our education and fellowship spaces, a new kitchen area, new bathrooms, and storage areas that will allow us to reclaim worship space in the sanctuary.

The estimated cost of the proposed project is 1.4 million dollars. Adding in our current mortgage, the total estimated cost would be 1.7 million dollars. We have partnered with LCEF Capital Funding Services and through prayer and discussion with our church leadership and with God providing immeasurably more than we can imagine, we believe this is within our grasp. Now is the time for us to consider how each of us can be a part of the future of Lord of the Lakes, with our prayers, time, gifts, talents, and treasures.

SCOPE OF WORK LEGEND

- Existing Space
- Interior Remodeled Space
- New / Remodeled Space

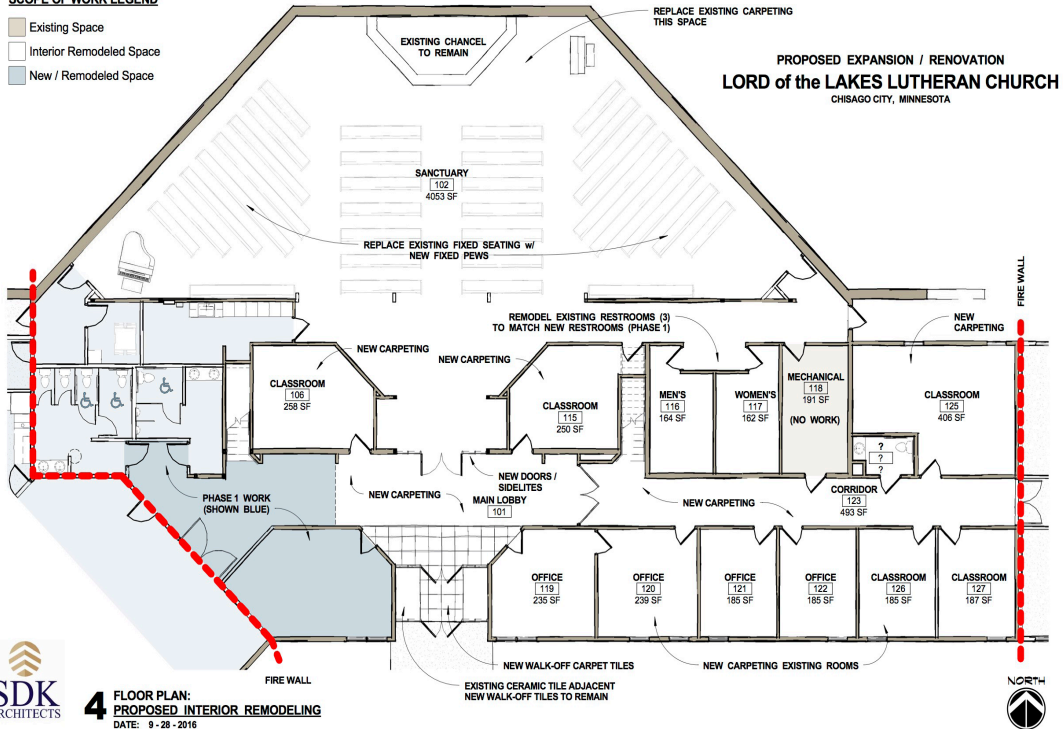

PROPOSED EXPANSION / RENOVATION **LORD of the LAKES LUTHERAN CHURCH** CHISAGO CITY, MINNESOTA

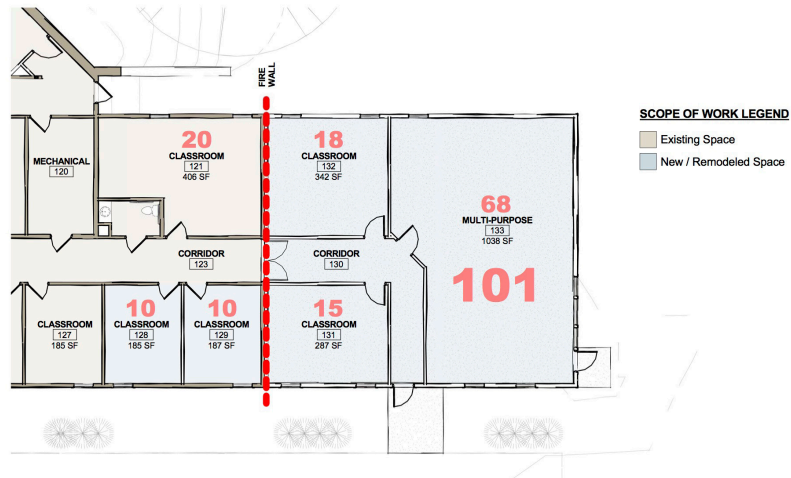

3 FLOOR PLAN: PROPOSED PHASE 2 ADDITION DATE: 9 - 28 - 2016



Today's Challenges...

At Lord of the Lakes we have been blessed to see our church growing, not just in numbers, but in enthusiasm and participation within our congregation. As a result, we are exceeding the capacity of our church in many areas.

Most noticeably, our Fellowship Hall is near capacity on many occasions, including Sunday morning Bible study, soup suppers, Christmas and Easter brunches, funerals, etc.

Increasingly, the sanctuary is near capacity, particularly for Christmas Eve and Easter Sunday services. We have had to use folding chairs and the balcony pews to accommodate worshipers.

The parking lot, in addition to increasing deterioration, has been at or beyond capacity on a number of occasions, even for regular Sunday services.

Our education capacity is being tested more and more often. We have outgrown the Bible Theater for Sunday School opening on a number of occasions. The Junior High class (grades 6-8) now numbers 11, plus 2 teachers, in a room that accommodates 14. Kool Kids reaches more than 15 children and is beginning to conflict with other activities, such as choir practice. A sizable space is needed for their activities.

But this is not about the building, nor is it about problems. Rather, it's about opportunities for our church to be a welcoming place, not just for our congregation, but for the community as well and to help us in reaching out to bring God's Word to those who need it.

The Expansion Includes...

Two new classrooms will be added as well as a large multipurpose room.
A new mechanical room and kitchen with walk in pantry will be added.
The fellowship hall will double in size and include a large storage space.
The new garage will be built on the west end of the parking lot.
Two new bathrooms (men's/women's) will be added.
The library will be reconfigured to fit the new doorway to the fellowship hall.
The walls separating storage in the sanctuary will be removed.
New carpet throughout the church.
New sanctuary seating.
New kitchen appliances.
Remodel for the current men's/women's bathrooms.

***"...Now, who is willing to consecrate
himself today to the Lord?
Then the leaders of families,
the officers of the tribes of Israel,
the commanders of thousands and
commanders of hundreds,
and the officials in charge of
the king's work gave willingly."***

1 Chronicles 29:5-6

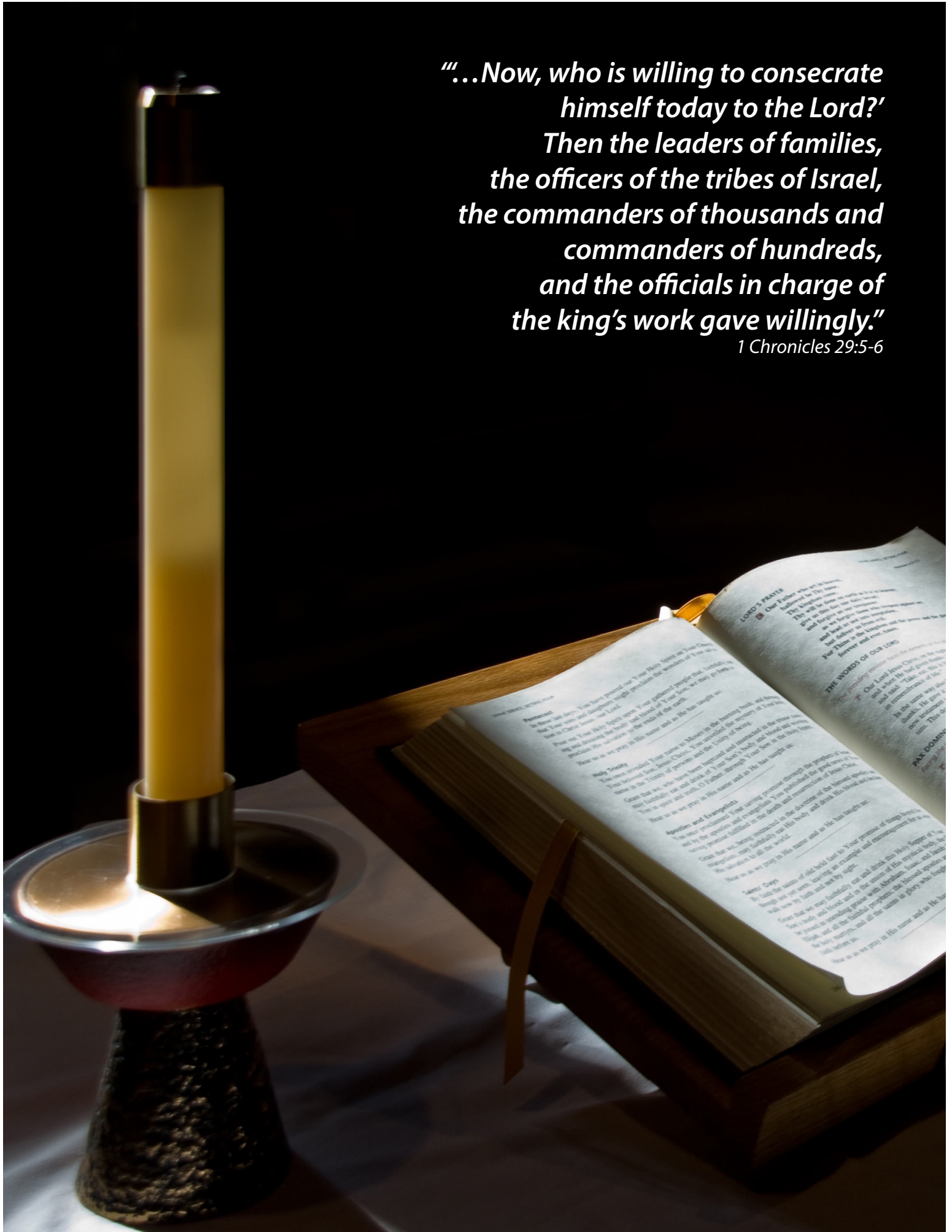

How can you be involved?

We would ask that you:

- Pray that God blesses this effort;
- Participate in the special worship services, Bible studies, and events;
- Prepare prayerfully to make a sacrificial gift in response to the love that God has shown you.

This is not simply a fundraising campaign; it is a spiritual journey. As we pray, participate, and prepare, we see the Spirit of Christ alive in our hearts and how He continues to work through us and among us to accomplish great things in the kingdom.

When responding, some members will look to their regular income as a source for their sacrificial gift over and above their regular giving. Others will look to appreciated assets. Others still will sell items they would be willing to do without.

Keep in mind that giving is a matter of priorities. Giving is a matter of willingness — not a matter of wealth. Giving is a matter of opportunity and joy — not a matter of obligation. Regardless, all will be done so that our congregation's ministry expansion can become a reality. Our congregation has had a very special way of responding to missions and ministry that is far beyond many congregations.

Donation Strategy

These are exciting times for the mission and ministry here at Lord of the Lakes! We're stepping forward in faith both spiritually and financially through a 3-year commitment to give "over and above" our regular tithes and offerings. The success of our campaign will depend on God's Holy Spirit blessing our congregation with willing, grateful, and joyful financial support. Please give prayerful consideration to your family's level of monthly giving for the next three years. Our stewardship goal of \$450,000 will be reached if all families of Lord of Lakes work together.

(If this many families commit to each of these 3 year totals, we will reach our goal of \$450,000.)

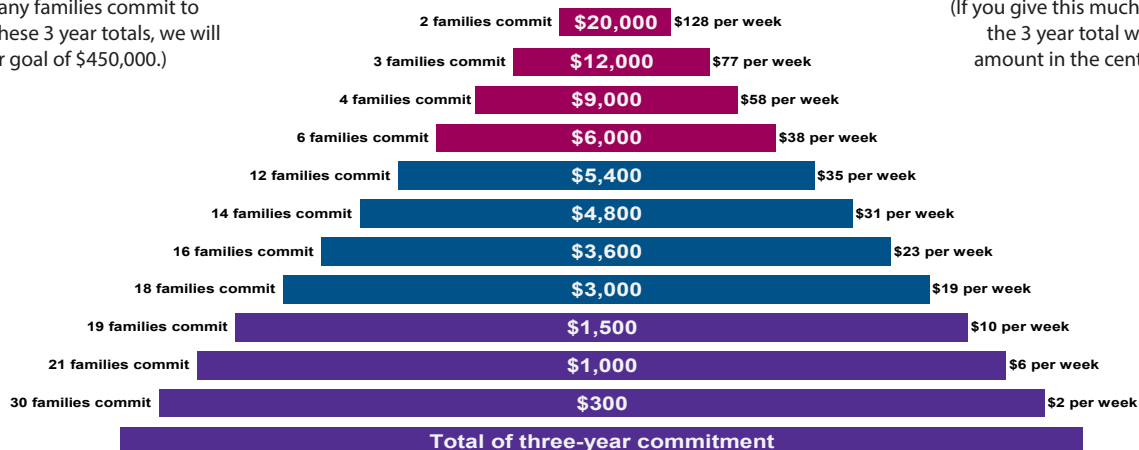

(If you give this much per month, the 3 year total will equal the amount in the center column.)

Giving is over 3 years, over and above our regular giving.

Frequently Asked Questions...

Why a Commitment Card?

A commitment card is a written testimony of your relationship with the Lord. Just as Jacob, in response to his relationship with the Lord, made a (pubic) vow to give a tenth to the Lord by setting up a stone pillar (Genesis 28:20-22), so shall we, in response to our relationship with the Lord, write out our intention. This written promise helps us prepare ourselves to be faithful to the Lord. This is not "a Law to live under" but a helpful reminder of our love for the Lord. Just as the Apostle Paul sent helpers to arrange for the gifts promised (2 Corinthians 9:5-8), your commitment card does the same. It helps you fulfill your promise to give generously from your heart.

What is meant by "sacrificial giving"?

Members of Lord of the Lakes have varying potential due to the nature of their work and compensation. Each family is challenged to give up something in order to make a special gift to the "Immeasurably More" campaign.

What will the money be used for?

This money will begin to pay for the building expansion and renovations that are currently being planned.

Will I be asked to make a public commitment?

No... your individual commitment will not be announced or published.

What if I'm in a financial hardship?

We all want to share. Hardships happen. God does not promise us an absence of trials but rather His love and support during them. If you are presently having an income shortage, for whatever reason, do not feel pressured to give. We understand. Something you can do is volunteer your time when projects need a few extra hands. Also, prayers are always welcome.

When can I make my commitments to the campaign?

Commitments will be made on December 4th at our "Commitment Celebration."

When do I start giving my gift?

January 8, 2017

Is it possible to make a gift before the end of the 2016 year for tax purposes?

Yes! Envelopes are available now or you can use your own as long as it is clearly marked "Building Fund."

Can we use electronic giving (EFT)?

Yes! Our "Simply Giving" forms have been updated and the "Building Fund" can be easily added to your existing electronic funds transfer (EFT). For more information on EFT, to make a change, or to sign up, please contact the church office. EFT has been a great blessing to our congregation - please consider signing up.

What about estate planning, my will, or donating money directly from my IRA?

Yes. This is all possible. Please see your tax or financial advisor. There are new laws that let you donate, under certain circumstances, income tax free. The Lutheran Church Extension Fund (LCEF) would be happy to assist in estate planning.

Will we continue to use pews in the sanctuary?

It has been made clear that the congregation's desire is to have pews - that is the current plan.

Will we be keeping separate track of “Building Fund” gifts?

Yes. It is necessary for our loan and campaign to keep track of “Building Fund” gifts separately. For the sake of book keeping we do ask that you use “Building Fund” envelopes or mark your gifts very clearly.

What if I have other questions?

Please ask!! Anyone on the Capital Campaign Leadership Team (listed below) would be happy to answer questions or find the answer if they don’t personally know.

What will I be asked to do during this campaign?

Read the material that is being sent your way. You are being asked to attend events that will help explain the needs of Lord of the Lakes and the purpose of this campaign. Pray to the Holy Spirit to guide you on your stewardship journey or giving sacrificially.

Capital Campaign Leadership Team...

Ministry Team

Pastor Craig Bertram

Campaign Director

Shelly Carlson

Campaign Director, Emeritus

Brad Johanson

Prayer Director

Dean Swenson

Campaign Coordinator

Faye Hansen

Communication Directors

Julie Schneider

David Siddall

Peggy Siddall

Inform Director

Chris Farrier

RSVP Directors

Curt Heacox

Nancy Heacox

Initial Commitments Directors

Marge Bertram

Nancy Heacox

Commitment Celebration Director

Peggy Siddall

Follow Up Director

Jeff Huenink

Janet Huenink

Youth Emphasis Director

Nancy Vitalis

Children’s Emphasis Director

Mark Fischer

Rebecca Fischer

Statements of Faith...

"Lord of the Lakes has certainly been a blessing to its members and the community. As a member it is important for each of us to recognize that this expansion is designed for one specific goal: to further the name of our Lord and Savior, Jesus Christ in our area, state, country and world. Regardless of the size/shape of our building, it is just that, a building. This expansion is not needed to create an earthly monolith, but to utilize the time, talent and treasure that Christ has provided each of us, allowing us to create additional space for us to provide the soul saving message of Jesus Christ and Him crucified. I encourage everyone to give generously to this campaign to allow Lord of the Lakes to continue to be a blessing to its members, community and to a lost world in need of Christ's saving message!" -Daryl Doeher

"The youth group at Lord of the Lakes has allowed me to make friends that I never would've made otherwise. Wednesday nights and Sunday mornings are some of my favorite parts of the week. Being able to come together and have engaging conversation about what's been going on in our lives, and real issues that we face and are going to face in our lives is my favorite part. It is nice to know that these people will always be there for you even though you may not talk or see them everyday." Erin McCleary

"Lord of the Lakes Lutheran Church has been much more than just a place for me to go to worship on Sunday mornings. I grew up in this congregation, my family joined here when I was a baby and now 30 plus years later I am raising my own family in this congregation as well. Here I have an entire community that has taken me in as a part of their family. They have taken the time to participate in my faith journey and to teach me by their actions and words what it looks like to be a Christian. This same community is now also demonstrating to my children what Christianity looks like. My prayer is that through this expansion, our congregation will be able to grow in our community and increase our family in Christ." Jennifer Fiske

"... Everything comes from you, and we have given you only what comes from your hand.... O Lord our God, as for all this abundance that we have provided for building you a temple for your Holy Name, it comes from your hand, and all of it belongs to you" 1 Chronicles 29:14-16